

KIBOS ROAD

KIBOS ROAD

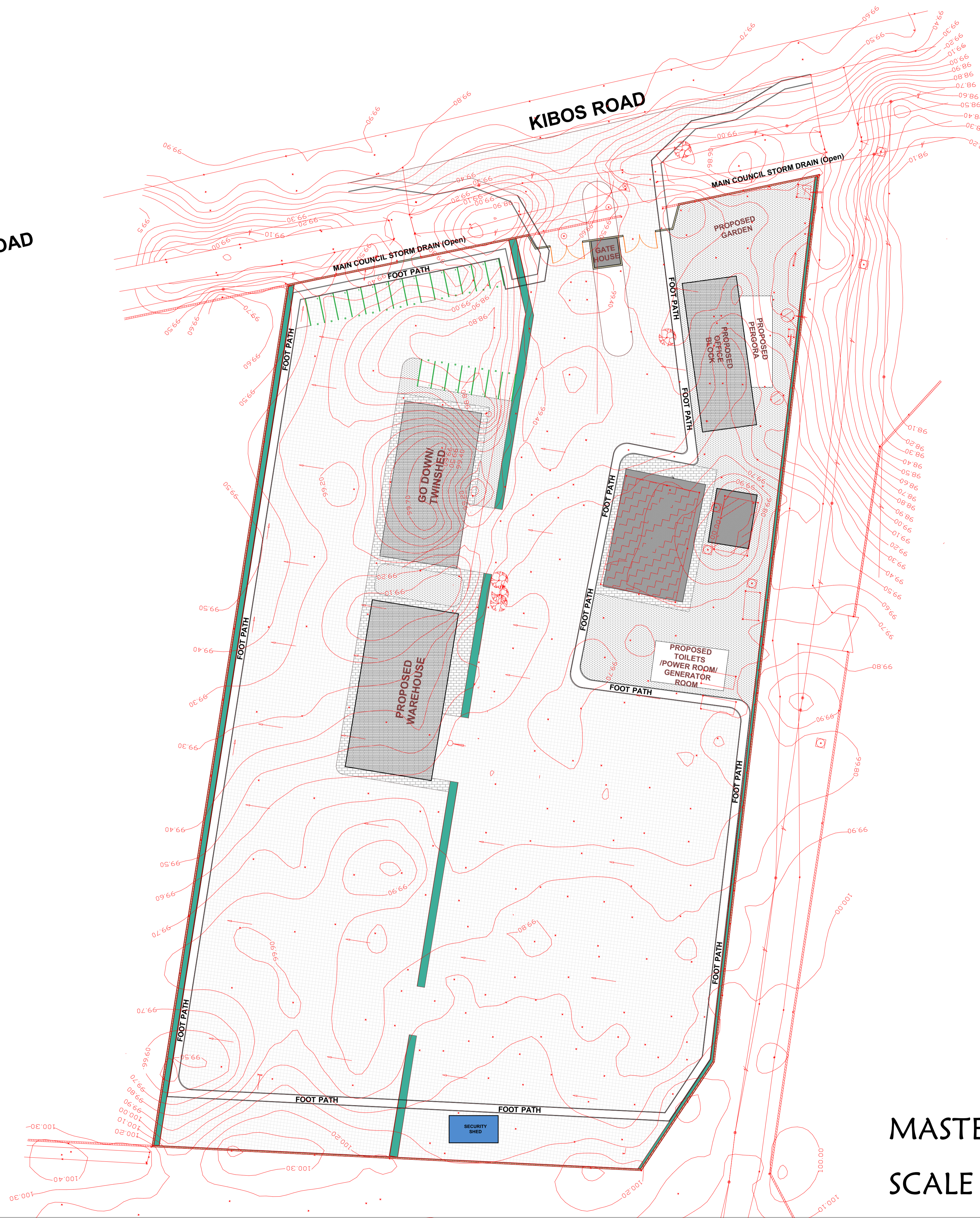

MASTER LAYOUT  
SCALE 1.500

NOTES

GENERAL

1. All dimensions in mm
- 2.No scaling of drawing. Contractor to check all dimensions and setting out and confirm with architect and or engineer as necessary.
3. Any discrepancy should be notified immediately to the designer and clarified by consulting the respective consultants' drawings.
4. Permanent vents (pv) to be provided to all windows and doors except wc doors.

STRUCTURAL

9. All RC works to be in accordance to engineer's detail.

MECHANICAL

11. All plumbing and drainage to comply with MoPW's specification.
12. All service ducts to be accessible from all floors.
14. Deep seal or anti-vac to all fittings connected to the SVP's or waste pipes.
15. All bends and junctions to have inspection plates .16. Drain pipes passing beneath buildings and driveways to be encased in 150mm concert surround
- 17.All underground foul and waste drain pipes shall be cast iron to comply to BS41514 and 5225.

ELECTRICAL

- 26.All Electrical works must be co-ordinated with mechanical works.
27. Any conflicts must be clarified before work

Revisions

No.	Description

Project

COMPLETION OF PROPOSED STORAGE FACILITIES FOR (RREC) AT KISUMU

Drawing title

MASTER LAYOUT

CLIENT

RURAL ELECTRIFICATION & RENEWABLE ENERGY CORPORATION (RREC)

Client signature

Scale	1:500

Project Job no.

WP ITEM NO. D1152 NY/KSM/2202 JOB NO. 111388

Name	Signed	Date
Drawn & Designed	Arch. Wacuka T.W.	May, 2024
Checked	Arch. J.K. Munyiri	May, 2024

APPROVED

Arch. L.M.Mochama  
B.Arch (HONS) M.A.A.K(A) CHIEF ARCHITECT



FOR THE GOVERNMENT OF THE REPUBLIC OF KENYA